

# DIN24155 Annex 2

July 1966 Issue

Angle flanges for HVAC Systems



## Material

1.0038 mild & galvanized steel

1.4301, 1.4571

further materials on request

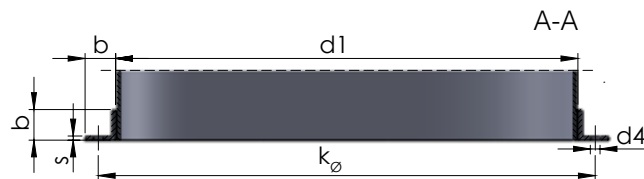
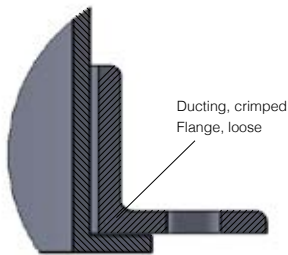

| DN<br>Nominal<br>Diameter | Inside- $\phi$<br>d1 | Material<br>Dimensions<br>(b x b x s) | Pitch<br>Circle<br>Diameter<br>$k_{\phi}$ | N° of<br>Bolt<br>Holes | Bolt-<br>Hole- $\phi$<br>d4 | Weight | Part N°<br>1.0038 mild | Part N°<br>1.0038<br>galvanized | Part N°<br>1.4301 | Part N°<br>1.4571 |
|---------------------------|----------------------|---------------------------------------|---|------------------------|-----------------------------|--------|------------------------|---------------------------------|-------------------|-------------------|
| 140                       | 146                  | 25 x 25 x 3                           | 176                                       | 6                      | 7                           | 0,66   | 24155-2-146            | 24155-2-146-V                   | 24155-2-146-01    | 24155-2-146-71    |
| 150                       | 155                  | 25 x 25 x 3                           | 185                                       | 6                      | 7                           | 0,63   | 24155-2-155            | 24155-2-155-V                   | 24155-2-155-01    | 24155-2-155-71    |
| 160                       | 164                  | 25 x 25 x 3                           | 194                                       | 6                      | 7                           | 0,66   | 24155-2-164            | 24155-2-164-V                   | 24155-2-164-01    | 24155-2-164-71    |
| 180                       | 183                  | 25 x 25 x 3                           | 213                                       | 6                      | 7                           | 0,72   | 24155-2-183            | 24155-2-183-V                   | 24155-2-183-01    | 24155-2-183-71    |
| 200                       | 205                  | 25 x 25 x 3                           | 235                                       | 6                      | 7                           | 0,80   | 24155-2-205            | 24155-2-205-V                   | 24155-2-205-01    | 24155-2-205-71    |
| 224                       | 229                  | 25 x 25 x 3                           | 259                                       | 6                      | 7                           | 0,88   | 24155-2-229            | 24155-2-229-V                   | 24155-2-229-01    | 24155-2-229-71    |
| 250                       | 256                  | 25 x 25 x 3                           | 286                                       | 6                      | 7                           | 0,98   | 24155-2-256            | 24155-2-256-V                   | 24155-2-256-01    | 24155-2-256-71    |
| 280                       | 288                  | 30 x 30 x 4                           | 322                                       | 8                      | 9,5                         | 1,76   | 24155-2-288            | 24155-2-288-V                   | 24155-2-288-01    | 24155-2-288-71    |
| 300                       | 305                  | 30 x 30 x 4                           | 339                                       | 8                      | 9,5                         | 1,85   | 24155-2-305            | 24155-2-305-V                   | 24155-2-305-01    | 24155-2-305-71    |
| 315                       | 322                  | 30 x 30 x 4                           | 356                                       | 8                      | 9,5                         | 1,94   | 24155-2-322            | 24155-2-322-V                   | 24155-2-322-01    | 24155-2-322-71    |
| 350                       | 355                  | 30 x 30 x 4                           | 394                                       | 8                      | 9,5                         | 2,13   | 24155-2-355            | 24155-2-355-V                   | 24155-2-355-01    | 24155-2-355-71    |
| 355                       | 361                  | 30 x 30 x 4                           | 395                                       | 8                      | 9,5                         | 2,16   | 24155-2-361            | 24155-2-361-V                   | 24155-2-361-01    | 24155-2-361-71    |
| 400                       | 404                  | 30 x 30 x 4                           | 438                                       | 12                     | 9,5                         | 2,40   | 24155-2-404            | 24155-2-404-V                   | 24155-2-404-01    | 24155-2-404-71    |
| 450                       | 453                  | 30 x 30 x 4                           | 487                                       | 12                     | 9,5                         | 2,67   | 24155-2-453            | 24155-2-453-V                   | 24155-2-453-01    | 24155-2-453-71    |
| 500                       | 507                  | 30 x 30 x 4                           | 541                                       | 12                     | 9,5                         | 2,97   | 24155-2-507            | 24155-2-507-V                   | 24155-2-507-01    | 24155-2-507-71    |
| 560                       | 569                  | 35 x 35 x 4                           | 605                                       | 16                     | 11,5                        | 3,93   | 24155-2-569            | 24155-2-569-V                   | 24155-2-569-01    | 24155-2-569-71    |
| 600                       | 605                  | 35 x 35 x 4                           | 641                                       | 16                     | 11,5                        | 4,15   | 24155-2-605            | 24155-2-605-V                   | 24155-2-605-01    | 24155-2-605-71    |
| 630                       | 638                  | 35 x 35 x 4                           | 674                                       | 16                     | 11,5                        | 4,38   | 24155-2-638            | 24155-2-638-V                   | 24155-2-638-01    | 24155-2-638-71    |
| 710                       | 715                  | 35 x 35 x 4                           | 751                                       | 16                     | 11,5                        | 4,88   | 24155-2-715            | 24155-2-715-V                   | 24155-2-715-01    | 24155-2-715-71    |
| 800                       | 801                  | 35 x 35 x 4                           | 837                                       | 24                     | 11,5                        | 5,44   | 24155-2-801            | 24155-2-801-V                   | 24155-2-801-01    | 24155-2-801-71    |
| 900                       | 898                  | 35 x 35 x 4                           | 934                                       | 24                     | 11,5                        | 6,07   | 24155-2-898            | 24155-2-898-V                   | 24155-2-898-01    | 24155-2-898-71    |
| 1000                      | 1007                 | 35 x 35 x 4                           | 1043                                      | 24                     | 11,5                        | 6,78   | 24155-2-1007           | 24155-2-1007-V                  | 24155-2-1007-01   | 24155-2-1007-71   |
| 1120                      | 1130                 | 40 x 40 x 4                           | 1174                                      | 24                     | 11,5                        | 8,77   | 24155-2-1130           | 24155-2-1130-V                  | 24155-2-1130-01   | 24155-2-1130-71   |
| 1250                      | 1267                 | 40 x 40 x 4                           | 1311                                      | 24                     | 11,5                        | 9,80   | 24155-2-1267           | 24155-2-1267-V                  | 24155-2-1267-01   | 24155-2-1267-71   |
| 1400                      | 1421                 | 40 x 40 x 4                           | 1465                                      | 24                     | 11,5                        | 10,95  | 24155-2-1421           | 24155-2-1421-V                  | 24155-2-1421-01   | 24155-2-1421-71   |
| 1600                      | 1593                 | 40 x 40 x 4                           | 1637                                      | 32                     | 11,5                        | 12,24  | 24155-2-1593           | 24155-2-1593-V                  | 24155-2-1593-01   | 24155-2-1593-71   |
| 1800                      | 1786                 | 40 x 40 x 4                           | 1830                                      | 32                     | 11,5                        | 13,69  | 24155-2-1786           | 24155-2-1786-V                  | 24155-2-1786-01   | 24155-2-1786-71   |
| 2000                      | 2003                 | 40 x 40 x 4                           | 2047                                      | 32                     | 11,5                        | 15,32  | 24155-2-2003           | 24155-2-2003-V                  | 24155-2-2003-01   | 24155-2-2003-71   |

All measurements are in millimetres and weights in kg.

# DIN24155 Annex 3

July 1966 Issue

Angle flanges for HVAC Systems



## Material

1.0038 mild & galvanized steel

1.4301, 1.4571

further materials on request

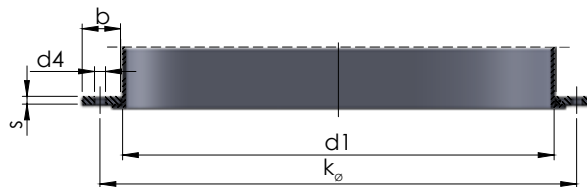
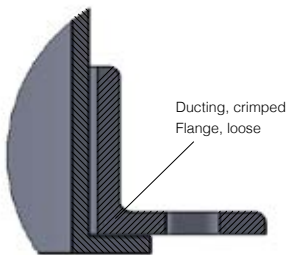

| DN<br>Nominal<br>Diameter | Inside-ø<br>d1 | Material<br>Dimensions<br>(b x b x s) | Pitch<br>Circle<br>Diameter<br>k <sub>ø</sub> | N° of<br>Bolt<br>Holes | Bolt-<br>Hole-ø<br>d4 | Weight | Part N°<br>1.0038 mild | Part N°<br>1.0038<br>galvanized | Part N°<br>1.4301 | Part N°<br>1.4571 |
|---------------------------|----------------|---------------------------------------|---|------------------------|-----------------------|--------|------------------------|---------------------------------|-------------------|-------------------|
| 140                       | 146            | 25 x 25 x 4                           | 176   | 6                      | 7                     | 0,78   | 24155-3-146            | 24155-3-146-V                   | 24155-3-146-01    | 24155-3-146-71    |
| 150                       | 155            | 25 x 25 x 4                           | 185   | 6                      | 7                     | 0,82   | 24155-3-155            | 24155-3-155-V                   | 24155-3-155-01    | 24155-3-155-71    |
| 160                       | 164            | 25 x 25 x 4                           | 194   | 6                      | 7                     | 0,86   | 24155-3-164            | 24155-3-164-V                   | 24155-3-164-01    | 24155-3-164-71    |
| 180                       | 183            | 25 x 25 x 4                           | 213   | 6                      | 7                     | 0,94   | 24155-3-183            | 24155-3-183-V                   | 24155-3-183-01    | 24155-3-183-71    |
| 200                       | 205            | 25 x 25 x 4                           | 235   | 6                      | 7                     | 1,04   | 24155-3-205            | 24155-3-205-V                   | 24155-3-205-01    | 24155-3-205-71    |
| 224                       | 229            | 25 x 25 x 4                           | 259   | 6                      | 7                     | 1,15   | 24155-3-229            | 24155-3-229-V                   | 24155-3-229-01    | 24155-3-229-71    |
| 250                       | 256            | 25 x 25 x 4                           | 286   | 6                      | 7                     | 1,28   | 24155-3-256            | 24155-3-256-V                   | 24155-3-256-01    | 24155-3-256-71    |
| 280                       | 288            | 30 x 30 x 5                           | 322   | 8                      | 9,5                   | 2,16   | 24155-3-288            | 24155-3-288-V                   | 24155-3-288-01    | 24155-3-288-71    |
| 300                       | 305            | 30 x 30 x 5                           | 339   | 8                      | 9,5                   | 2,27   | 24155-3-305            | 24155-3-305-V                   | 24155-3-305-01    | 24155-3-305-71    |
| 315                       | 322            | 30 x 30 x 5                           | 356   | 8                      | 9,5                   | 2,39   | 24155-3-322            | 24155-3-322-V                   | 24155-3-322-01    | 24155-3-322-71    |
| 350                       | 355            | 30 x 30 x 5                           | 389   | 8                      | 9,5                   | 2,61   | 24155-3-355            | 24155-3-355-V                   | 24155-3-355-01    | 24155-3-355-71    |
| 355                       | 361            | 30 x 30 x 5                           | 395   | 8                      | 9,5                   | 2,65   | 24155-3-361            | 24155-3-361-V                   | 24155-3-361-01    | 24155-3-361-71    |
| 400                       | 404            | 30 x 30 x 5                           | 438   | 12                     | 9,5                   | 2,94   | 24155-3-404            | 24155-3-404-V                   | 24155-3-404-01    | 24155-3-404-71    |
| 450                       | 453            | 30 x 30 x 5                           | 487   | 12                     | 9,5                   | 3,28   | 24155-3-453            | 24155-3-453-V                   | 24155-3-453-01    | 24155-3-453-71    |
| 500                       | 507            | 30 x 30 x 5                           | 541   | 12                     | 9,5                   | 3,64   | 24155-3-507            | 24155-3-507-V                   | 24155-3-507-01    | 24155-3-507-71    |
| 560                       | 569            | 35 x 35 x 5                           | 605   | 16                     | 11,5                  | 4,84   | 24155-3-569            | 24155-3-569-V                   | 24155-3-569-01    | 24155-3-569-71    |
| 600                       | 605            | 35 x 35 x 5                           | 641   | 16                     | 11,5                  | 5,13   | 24155-3-605            | 24155-3-605-V                   | 24155-3-605-01    | 24155-3-605-71    |
| 630                       | 638            | 35 x 35 x 5                           | 674   | 16                     | 11,5                  | 5,39   | 24155-3-638            | 24155-3-638-V                   | 24155-3-638-01    | 24155-3-638-71    |
| 710                       | 715            | 35 x 35 x 5                           | 751   | 16                     | 11,5                  | 6,01   | 24155-3-715            | 24155-3-715-V                   | 24155-3-715-01    | 24155-3-715-71    |
| 800                       | 801            | 35 x 35 x 5                           | 837   | 24                     | 11,5                  | 6,70   | 24155-3-801            | 24155-3-801-V                   | 24155-3-801-01    | 24155-3-801-71    |
| 900                       | 898            | 35 x 35 x 5                           | 934   | 24                     | 11,5                  | 7,48   | 24155-3-898            | 24155-3-898-V                   | 24155-3-898-01    | 24155-3-898-71    |
| 1000                      | 1007           | 35 x 35 x 5                           | 1043  | 24                     | 11,5                  | 8,35   | 24155-3-1007           | 24155-3-1007-V                  | 24155-3-1007-01   | 24155-3-1007-71   |
| 1120                      | 1130           | 40 x 40 x 6                           | 1174  | 24                     | 11,5                  | 12,81  | 24155-3-1130           | 24155-3-1130-V                  | 24155-3-1130-01   | 24155-3-1130-71   |
| 1250                      | 1267           | 40 x 40 x 6                           | 1311  | 24                     | 11,5                  | 14,31  | 24155-3-1267           | 24155-3-1267-V                  | 24155-3-1267-01   | 24155-3-1267-71   |
| 1400                      | 1421           | 40 x 40 x 6                           | 1465  | 24                     | 11,5                  | 16,00  | 24155-3-1421           | 24155-3-1421-V                  | 24155-3-1421-01   | 24155-3-1421-71   |
| 1600                      | 1593           | 40 x 40 x 6                           | 1637  | 32                     | 11,5                  | 17,88  | 24155-3-1593           | 24155-3-1593-V                  | 24155-3-1593-01   | 24155-3-1593-71   |
| 1800                      | 1786           | 40 x 40 x 6                           | 1830  | 32                     | 11,5                  | 19,99  | 24155-3-1786           | 24155-3-1786-V                  | 24155-3-1786-01   | 24155-3-1786-71   |
| 2000                      | 2003           | 40 x 40 x 6                           | 2047  | 32                     | 11,5                  | 22,37  | 24155-3-2003           | 24155-3-2003-V                  | 24155-3-2003-01   | 24155-3-2003-71   |

All measurements are in millimetres and weights in kg.

# DIN24155 Annex 4

July 1966 Issue

Angle flanges for HVAC Systems



## Material

1.0038 mild & galvanized steel

1.4301, 1.4571

further materials on request

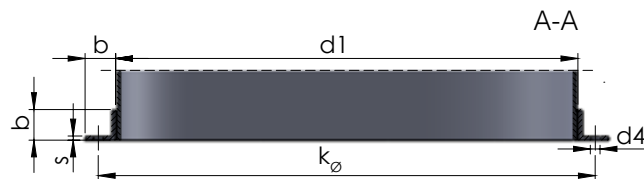
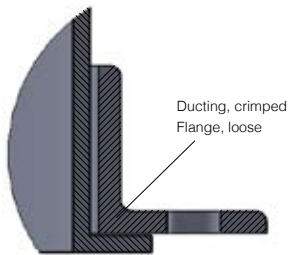

| DN<br>Nominal<br>Diameter | Inside-ø<br>d1 | Material<br>Dimensions<br>(b x b x s) | Pitch<br>Circle<br>Diameter<br>$k_{\varnothing}$ | N° of<br>Bolt<br>Holes | Bolt-<br>Hole-ø<br>d4 | Weight | Part N°<br>1.0038 mild | Part N°<br>1.0038<br>galvanized | Part N°<br>1.4301 | Part N°<br>1.4571 |
|---------------------------|----------------|---------------------------------------|--|------------------------|-----------------------|--------|------------------------|---------------------------------|-------------------|-------------------|
| 140                       | 146            | 35 x 35 x 5                           | 182  | 8                      | 11,5                  | 1,45   | 24155-4-146            | 24155-4-146-V                   | 24155-4-146-01    | 24155-4-146-71    |
| 150                       | 155            | 35 x 35 x 5                           | 191  | 8                      | 11,5                  | 1,52   | 24155-4-155            | 24155-4-155-V                   | 24155-4-155-01    | 24155-4-155-71    |
| 160                       | 164            | 35 x 35 x 5                           | 200  | 8                      | 11,5                  | 1,59   | 24155-4-164            | 24155-4-164-V                   | 24155-4-164-01    | 24155-4-164-71    |
| 180                       | 183            | 35 x 35 x 5                           | 219  | 8                      | 11,5                  | 1,75   | 24155-4-183            | 24155-4-183-V                   | 24155-4-183-01    | 24155-4-183-71    |
| 200                       | 205            | 35 x 35 x 5                           | 241  | 8                      | 11,5                  | 1,92   | 24155-4-205            | 24155-4-205-V                   | 24155-4-205-01    | 24155-4-205-71    |
| 224                       | 229            | 35 x 35 x 5                           | 265  | 8                      | 11,5                  | 2,12   | 24155-4-229            | 24155-4-229-V                   | 24155-4-229-01    | 24155-4-229-71    |
| 250                       | 256            | 35 x 35 x 5                           | 292  | 8                      | 11,5                  | 2,33   | 24155-4-256            | 24155-4-256-V                   | 24155-4-256-01    | 24155-4-256-71    |
| 280                       | 288            | 40 x 40 x 6                           | 332  | 8                      | 11,5                  | 3,59   | 24155-4-288            | 24155-4-288-V                   | 24155-4-288-01    | 24155-4-288-71    |
| 300                       | 305            | 40 x 40 x 6                           | 349  | 8                      | 11,5                  | 3,78   | 24155-4-305            | 24155-4-305-V                   | 24155-4-305-01    | 24155-4-305-71    |
| 315                       | 322            | 40 x 40 x 6                           | 366  | 8                      | 11,5                  | 3,96   | 24155-4-322            | 24155-4-322-V                   | 24155-4-322-01    | 24155-4-322-71    |
| 350                       | 355            | 40 x 40 x 6                           | 399  | 8                      | 11,5                  | 4,33   | 24155-4-355            | 24155-4-355-V                   | 24155-4-355-01    | 24155-4-355-71    |
| 355                       | 361            | 40 x 40 x 6                           | 405  | 8                      | 11,5                  | 4,39   | 24155-4-361            | 24155-4-361-V                   | 24155-4-361-01    | 24155-4-361-71    |
| 400                       | 404            | 40 x 40 x 6                           | 448  | 12                     | 11,5                  | 4,86   | 24155-4-404            | 24155-4-404-V                   | 24155-4-404-01    | 24155-4-404-71    |
| 450                       | 453            | 40 x 40 x 6                           | 497  | 12                     | 11,5                  | 5,40   | 24155-4-453            | 24155-4-453-V                   | 24155-4-453-01    | 24155-4-453-71    |
| 500                       | 507            | 40 x 40 x 6                           | 551  | 12                     | 11,5                  | 5,99   | 24155-4-507            | 24155-4-507-V                   | 24155-4-507-01    | 24155-4-507-71    |
| 560                       | 569            | 50 x 50 x 6                           | 629  | 16                     | 14                    | 8,61   | 24155-4-569            | 24155-4-569-V                   | 24155-4-569-01    | 24155-4-569-71    |
| 600                       | 605            | 50 x 50 x 6                           | 665  | 16                     | 14                    | 9,11   | 24155-4-605            | 24155-4-605-V                   | 24155-4-605-01    | 24155-4-605-71    |
| 630                       | 638            | 50 x 50 x 6                           | 698  | 16                     | 14                    | 9,57   | 24155-4-638            | 24155-4-638-V                   | 24155-4-638-01    | 24155-4-638-71    |
| 710                       | 715            | 50 x 50 x 6                           | 775  | 16                     | 14                    | 10,64  | 24155-4-715            | 24155-4-715-V                   | 24155-4-715-01    | 24155-4-715-71    |
| 800                       | 801            | 50 x 50 x 6                           | 861  | 24                     | 14                    | 11,84  | 24155-4-801            | 24155-4-801-V                   | 24155-4-801-01    | 24155-4-801-71    |
| 900                       | 898            | 50 x 50 x 6                           | 958  | 24                     | 14                    | 13,19  | 24155-4-898            | 24155-4-898-V                   | 24155-4-898-01    | 24155-4-898-71    |
| 1000                      | 1007           | 50 x 50 x 6                           | 1067   | 24                     | 14                    | 14,70  | 24155-4-1007           | 24155-4-1007-V                  | 24155-4-1007-01   | 24155-4-1007-71   |
| 1120                      | 1130           | 60 x 60 x 8                           | 1200   | 32                     | 18                    | 26,30  | 24155-4-1130           | 24155-4-1130-V                  | 24155-4-1130-01   | 24155-4-1130-71   |
| 1250                      | 1267           | 60 x 60 x 8                           | 1337   | 32                     | 18                    | 29,32  | 24155-4-1267           | 24155-4-1267-V                  | 24155-4-1267-01   | 24155-4-1267-71   |
| 1400                      | 1421           | 60 x 60 x 8                           | 1491   | 32                     | 18                    | 32,73  | 24155-4-1421           | 24155-4-1421-V                  | 24155-4-1421-01   | 24155-4-1421-71   |
| 1600                      | 1593           | 60 x 60 x 8                           | 1663   | 40                     | 18                    | 36,53  | 24155-4-1593           | 24155-4-1593-V                  | 24155-4-1593-01   | 24155-4-1593-71   |
| 1800                      | 1786           | 60 x 60 x 8                           | 1856   | 40                     | 18                    | 40,79  | 24155-4-1786           | 24155-4-1786-V                  | 24155-4-1786-01   | 24155-4-1786-71   |
| 2000                      | 2003           | 60 x 60 x 8                           | 2073   | 40                     | 18                    | 45,59  | 24155-4-2003           | 24155-4-2003-V                  | 24155-4-2003-01   | 24155-4-2003-71   |

All measurements are in millimetres and weights in kg.

For stainless steel materials, the material thickness  $s$  deviates from the DIN.